



Vigolo Low Body Mulcher Features

Upper structure

Vigolo Low Body mulchers are prepared for frontal use, if needed, whereas the reversible version allows works both front and rear of tractor. The optional version with hydraulic side shift is available for all models of the portfolio. Vigolo headstocks are ment to last in every work condition, even under strong continuous strains.

Transmission

All Vigolo low body mulcher gearboxes are equipped with integrated freewheel. Thanks to a combination of power, torque and speed your high body mulcher is a top performer with a lower power requirement.

Lateral skids

All Vigolo low body mulchers can be equipped with optional skids with lower plate. The option of skids with lower plate, together with the rear roller, grants extra support to low body mulchers, eases a regular work and makes the the machine more stable.

Front protection

The standard equipment of Vigolo low body mulchers includes front protection through flaps made of galvanized iron; this creates a safe barrier which helps to avoid the coming out of the material cut. As an option is available the protection Vigolo offers a front protection with chains.

Technical solutions

The rounded case of the models RSA PLUS and RSA MAX allows an optimal work even very close to the trunks without ruining them; TSA/L is available also in the lower version for a perfect maintenance of the green under the foliage. As an option Vigolo offers the plant guard and the branch pick-up spikes on both sides of the machine for the models which though a special case are standard prepared for this kit (TSA/L, TSA/P, MX, RSA PLUS e RSA MAX).

Low Body Mulchers – Features

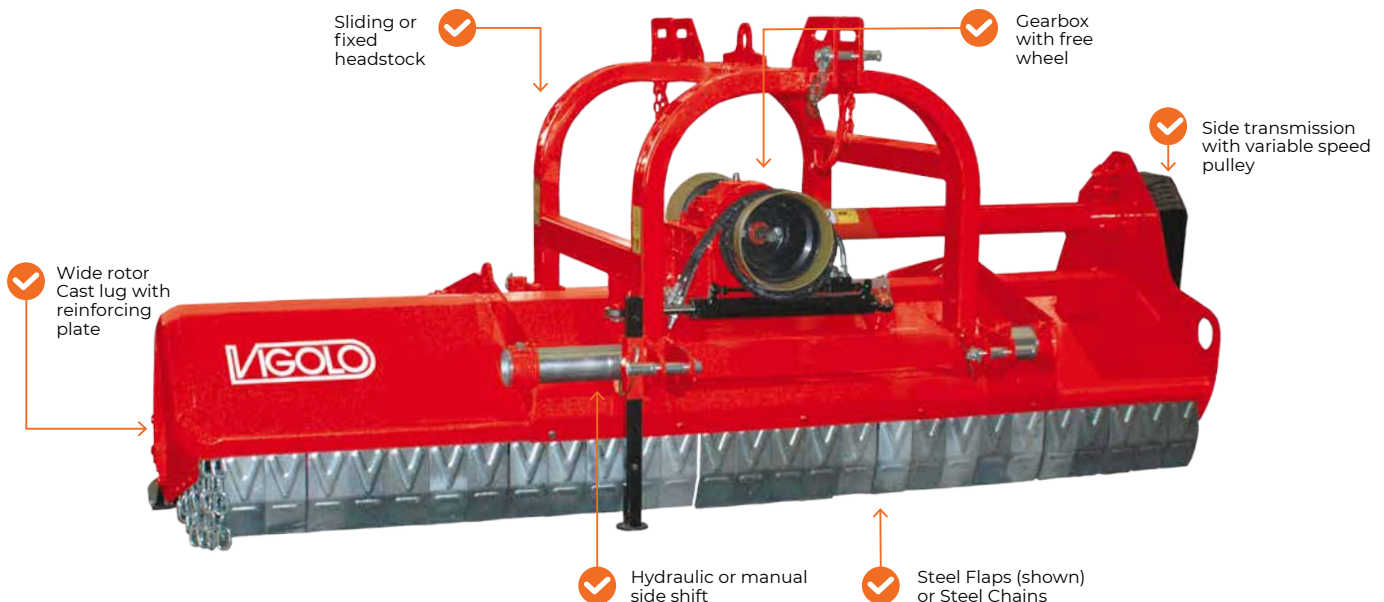

TK2 160 - 200

30 - 80 HP

Standard Equipment

- ▶ 80hp Gear Box w. Freewheel 540rpm
- ▶ 130mm Rotor w. Hammer Blades
- ▶ 114mm Rear Roller w. Height Adjustment
- ▶ Cat. I 3 Point ISO Head Stock
- ▶ Side Skids
- ▶ Mechanical Side Shift
- ▶ Opening Rear Door (Profi)
- ▶ Double Skin Body (Profi)
- ▶ Front Protection Plates

Options On Request

- ▶ Hydraulic Side Shift

PROFI Version (Shown)

- ▶ Double skinned body
- ▶ Opening rear door



MU2 180 - 250

45 - 100 HP

Standard Equipment

- ▶ 100hp Gear Box w. Freewheel 540/1000rpm
- ▶ 150mm Rotor w. Hammer Blades
- ▶ 154mm Rear Roller w. Height Adjustment
- ▶ Cat. I.II 3 Point ISO
- ▶ Head Stock Side Skids
- ▶ Mechanical Side Shift
- ▶ Double Counter Knife
- ▶ Front Protection Plates
- ▶ PTO Shaft (1.3/8 6 spline)

Options On Request

- ▶ Hydraulic Side Shift
- ▶ Front Mount Kit
- ▶ Rear Wheels (in lieu of roller)

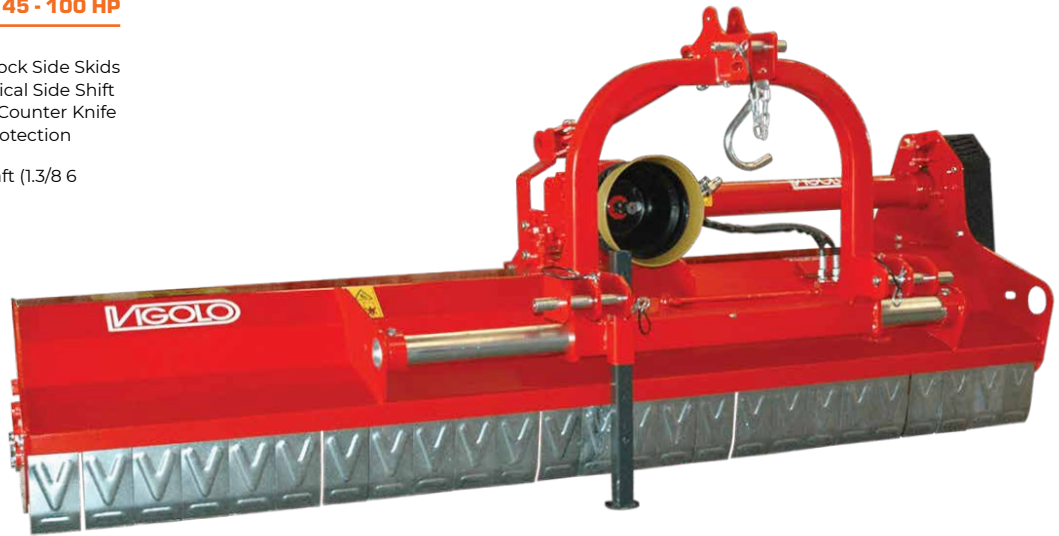

TK2 160 - 200

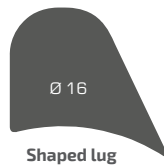
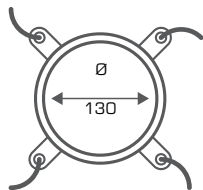

MU2 180 - 250

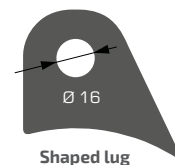
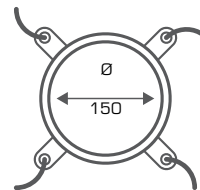

Model	Working width mm	Transport width mm	HP min - max	Kg	Rotor mm	Shaped lug mm	Rear roller mm	PTO shaft mm
TK2 160	1600	1725	30-80	320	18	56	± 125	3
TK2 180	1800	1925	40-80	350	20	60	± 125	4
TK2 200	2000	2125	40-80	370	22	64	± 125	4
TK2 160 PROFI	1600	1725	30-80	350	18	56	± 125	3
TK2 180 PROFI	1800	1925	40-80	380	20	60	± 125	4
TK2 200 PROFI	2000	2125	40-80	400	22	64	± 125	4
MU2 180	1800	1970	40-100	505	16	40	± 250	4
MU2 200	2000	2170	40-100	530	18	44	± 250	4
MU2 220	2200	3770	50-100	600	20	48	± 250	4
MU2 250	2500	2670	60-100	660	22	56	± 250	5

Low Body Mulchers



TSA/P 180 - 300

50 - 180 HP

Standard Equipment

- ▶ 120hp Gear Box w. Freewheel 540/1000rpm (180.250)
- ▶ 180hp Gear Box w. Freewheel 1000/540rpm (280.300)
- ▶ 194mm Rotor w. Hammer Blades
- ▶ 154mm Rear Roller w. Height Adjustment
- ▶ Cat. II 3 Point ISO Head
- ▶ Stock
- ▶ Side Skids
- ▶ Mechanical Side Shift
- ▶ Opening Rear Door
- ▶ Double Skin Body - HARDOX
- ▶ Triple Counter Knife
- ▶ Front Protection Plates
- ▶ PTO Shaft (1.3/8 6 spline)

Options On Request

- ▶ Hydraulic Side Shift
- ▶ Rear Wheels (in lieu of roller)
- ▶ Reversible Headstock/Front mounted linkage



RSA MAX 180 - 320

80 - 180 HP

Standard Equipment

- ▶ Standard Fitment
- ▶ 120hp Gear Box w. Freewheel 540/1000rpm (180.250)
- ▶ 180hp Gear Box w. Freewheel 1000/540rpm (280.320)
- ▶ 230mm Rotor w. Hammer Blades
- ▶ 194mm Rear Roller w. Height Adjustment
- ▶ Cat. II 3 Point ISO
- ▶ double Tube Head Stock
- ▶ Side Skids
- ▶ Hydraulic Side Shift
- ▶ Opening Rear Door
- ▶ Double Skin Body
- ▶ Triple Counter Knife
- ▶ Front Protection Chains
- ▶ PTO Shaft (1.3/8 6 spline)

Options On Request

- ▶ Reversible Headstock/Front mounted linkage



TSA/P

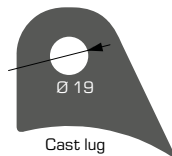
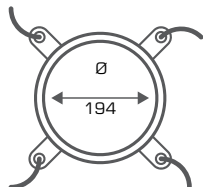

RSA Max

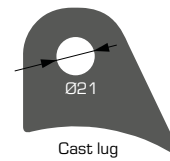
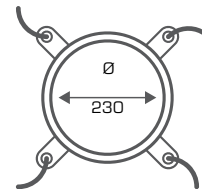

Model	Working width	Transport width	HP min - max	Kg	1	2	3	4	5
TSA/P 180	1800	1970	50-120	650	40	34		± 200	5
TSA/P 200	2000	2170	50-120	700	44	38		± 200	5
TSA/P 220	2200	2370	50-120	760	48	40		± 200	5
TSA/P 250	2500	2670	60-120	830	56	48		± 200	5
TSA/P 280	2800	2990	70-180	910	64	52		± 200	6
TSA/P 300	3000	3190	80-180	1000	68	56		± 200	6
RSA Max 180	1800	1990	80 - 120	840	16		32 + 16	± 200	5
RSA Max 200	2000	2190	90 - 120	840	18		36 + 18	± 200	5
RSA Max 220	2200	2390	100 - 120	960	20		40 + 20	± 200	5
RSA Max 250	2500	2690	100 - 120	1030	22		44 + 22	± 200	5
RSA Max 280	2800	2990	100 - 180	1100	24		48 + 24	± 200	6
RSA Max 300	3000	3190	120 - 180	1170	28		56 + 28	± 200	6
RSA Max 320	3200	3390	120 - 180	1200	32		64 + 32	± 200	6